



BLACK BOX[®]

NETWORK SERVICES

© 2002. All rights reserved.
Black Box Corporation.

Black Box Network Services • 464 Basingstoke Road • Reading, Berkshire, RG2 0BG • Tech Support: 0118 965 6000 • www.blackbox.co.uk • e-mail: techhelp@blackbox.co.uk

PUNCHDOWN TOOL WITH 110 BLADE AND LIGHT PACK

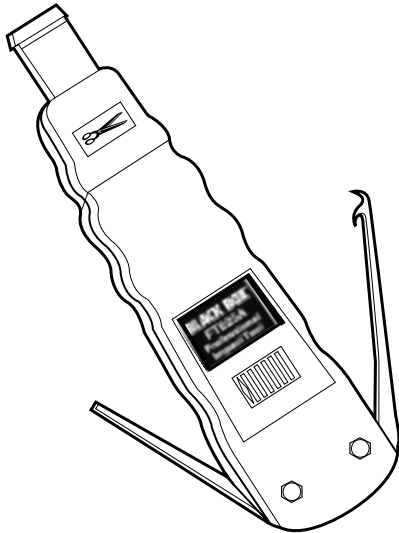

This handy punchdown tool includes a detachable light for working in dark cabinets and buildings without power.

Key Features

- ▶ **Cut and punchdown cable easily.**
- ▶ **Light the way in dark cabinets and buildings without power!**
- ▶ **Ideal for 28 to 22 AWG solid or stranded cable.**
- ▶ **Spring mechanism makes the tool easy to handle.**
- ▶ **Includes a 110 blade; other blades available include 66, Bix, and Krone.**

There's no need to bring a flashlight with you when you're installing cable in a dark cabinet or a building without power; the Punchdown Tool with 110 Blade and Light Pack lights the way!

The Tool's detachable light features a long-life LED that's specially designed to focus the light on the panel work area. The luminous intensity of the LED is 2200 millicandela (mcd).

You also get everything you need to cut and punchdown cable. The tool's ideal for 28 to 22 AWG solid or stranded wire or cable. Its spring mechanism requires minimal hand force to actuate. And a soft, rubber-embedded handle cushions your hand as you terminate the wires.

The tool comes with a 110 blade, but other blades are available to terminate and cut telephone and data cable into a variety of termination panels. Choose from 66, Bix, and Krone blades, or order a spare 110 blade. Blades twist and lock into place. The tool also accepts other manufacturers' twist-and-lock style blades. The blade is conveniently stored in the end of the handle.

Other features include a multi-use spudger, which works as a screwdriver or an IDC contact insertion tool.

The tool includes a hook to feed the wires through the holes. Use the pick to separate bonded twisted-pair cables or to strip insulation and cut wire.

An adjustable HI/LO spring compression works with all cable types.



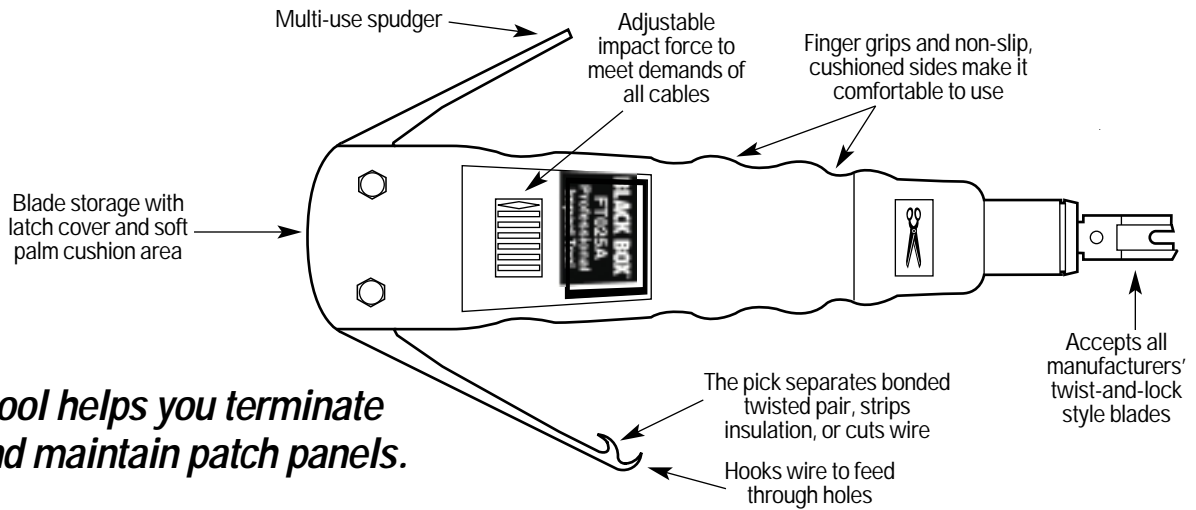

This tool helps you terminate wire and maintain patch panels.

Why Buy From Black Box? Exceptional Value. Exceptional Tech Support. Period.

Recognize any of these situations?

- You wait more than 30 minutes to get through to a vendor's tech support.
- The so-called "tech" can't help you or gives you the wrong answer.
- You don't have a purchase order number and the tech refuses to help you.
- It's 9 p. m. and you need help, but your vendor's tech support line is closed.

According to a survey by Data Communications magazine, 90% of network managers surveyed say that getting the technical support they need is extremely important when choosing a

vendor. But even though network managers pay anywhere from 10 to 20% of their overall purchase price for a basic service and support contract, the technical support and service they receive falls far short of their expectations—and certainly isn't worth what they paid.

At Black Box, we guarantee the best value and the best support. You can even consult our Technical Support Experts before you buy if you need help selecting just the right component for your application.

Don't waste time and money—call Black Box today.

Specifications

Size: 1"W x 6.25"L (2.5 x 15.9 cm)

Weight: 0.5 lb. (0.2 kg)

What's Included

- (1) Punchdown tool
- (1) 110 blade
- (1) Light system
- (1) Users' manual

Ordering Information

ITEM	CODE
Punchdown Tool with 110 Blade and Light Pack	FT025A
<i>You might also need accessories...</i>	
Handle only	FT024
110 Blade	FT026
66 Blade	FT027
Bix Blade	FT028
Krone Blade	FT029
Light System	FT030

